

100 CITY SQUARE

CHARLESTOWN | BOSTON, MA

TRANSIT-ORIENTED LOCATION SEAMLESSLY CONNECTED TO BOSTON

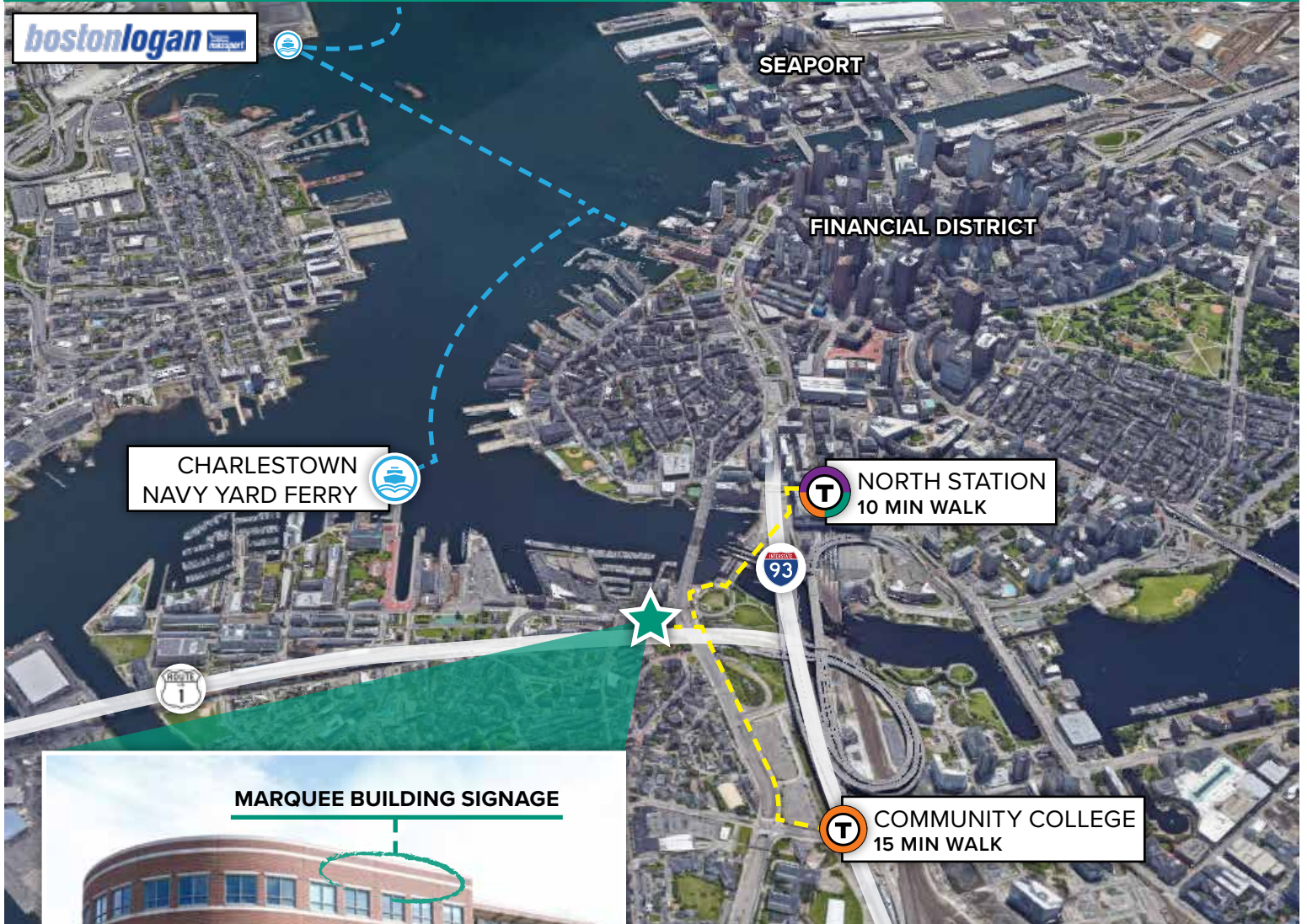

MARQUEE BUILDING SIGNAGE

GLOBAL HQ OPPORTUNITY

51,870 RSF Class A Office For Lease

LINCOLN
PROPERTY
COMPANY

HIGHLIGHTS

- ✔ Ground floor lobby with dedicated reception desk
- ✔ Private elevator access to 2nd and 3rd floors from the building's garage
- ✔ Views of Boston Harbor and Charles River
- ✔ On-site Parking Garage



Available space at 100 City Square is undergoing select demo. Photos show representative build-out and finishes at 80 City Square.



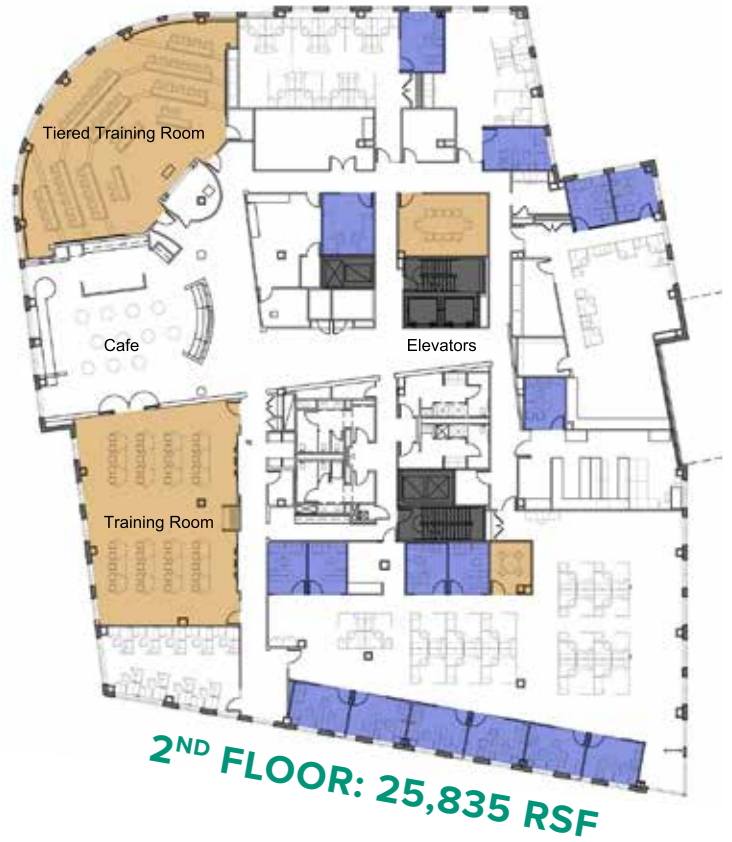

AVAILABLE SPACE

2nd Floor: 25,835 RSF

3rd Floor: 25,835 RSF

TOTAL: 51,870 RSF

Take a Tour

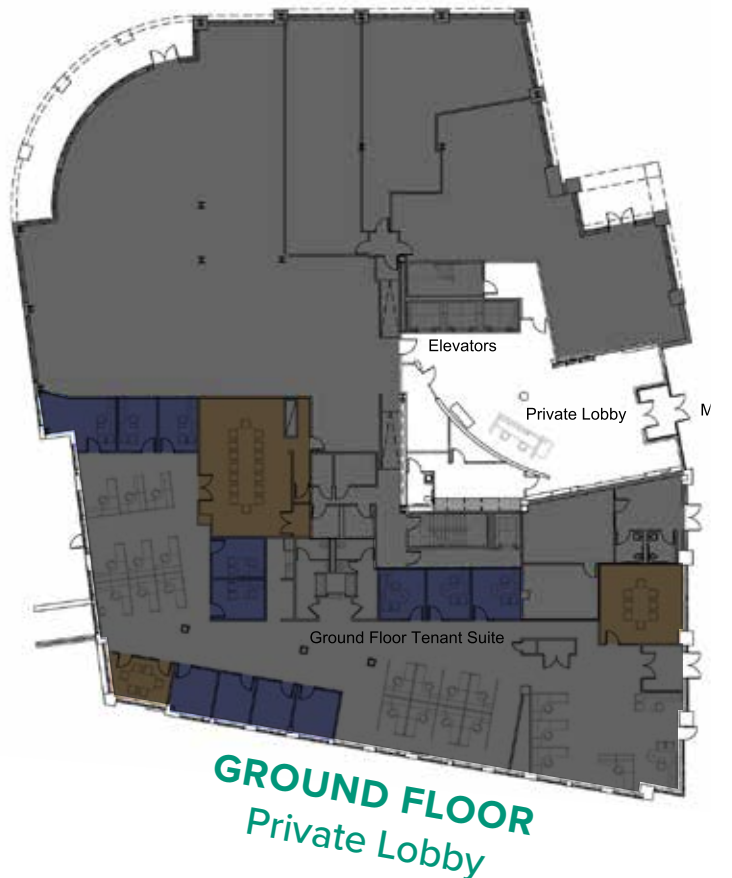

*Floor plans show existing conditions.
Select demo is underway.*

Floor Plan measurements are approximate and are for illustrative purposes only. While we do not doubt the floor plans accuracy, we make no guarantee, warranty or representation as to the accuracy and completeness of the floor plan.

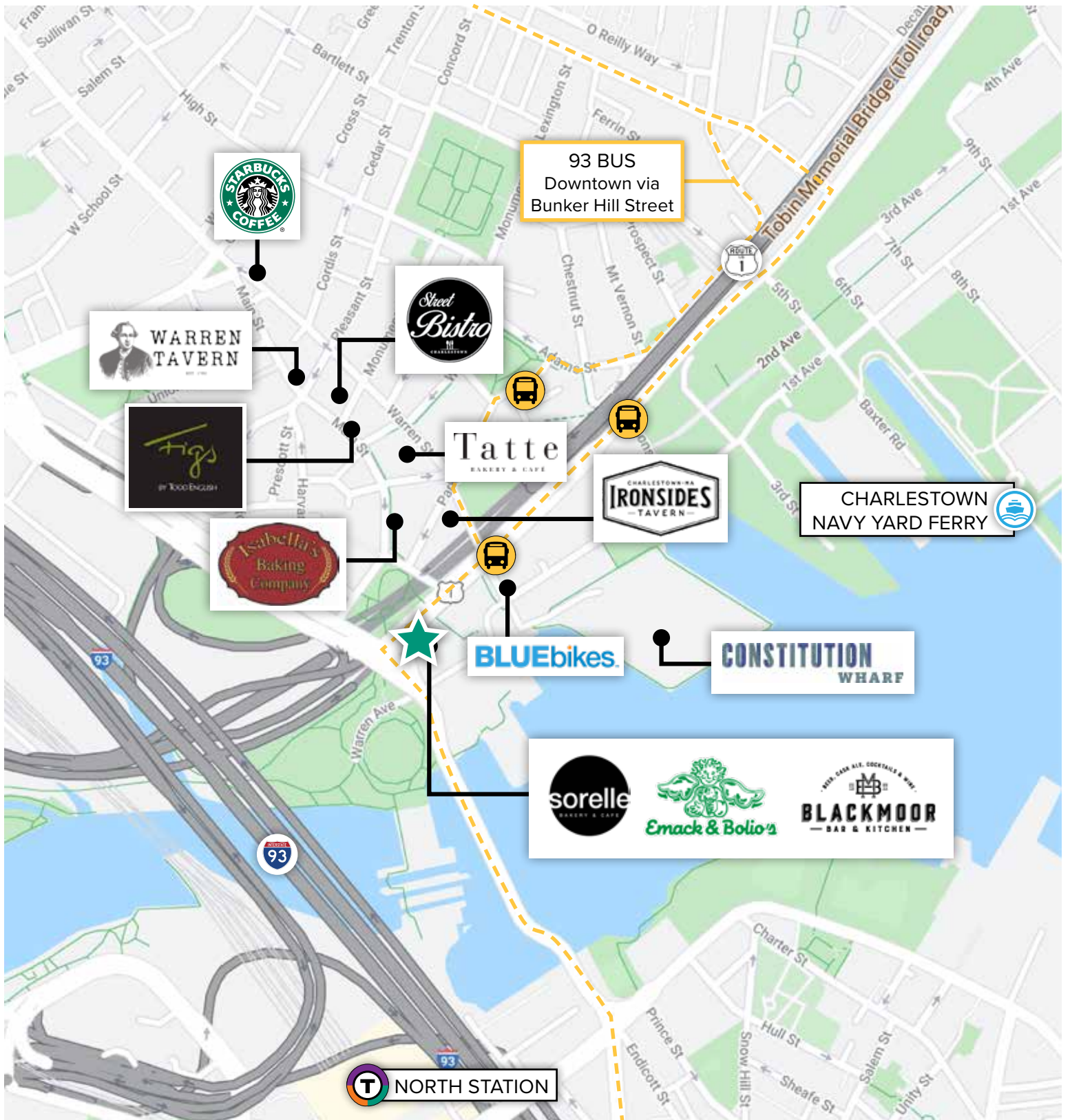

ROB CRONIN
Senior Vice President
 617.951.4147
 rcronin@lpc.com

BRENDAN MILLER
Senior Vice President
 617.951.4148
 bmiller@lpc.com

CHRISTOPHER SCOTT
Vice President
 617.951.4135
 cscott@lpc.com