

# 91

# HARTWELL AVENUE

LEXINGTON, MA

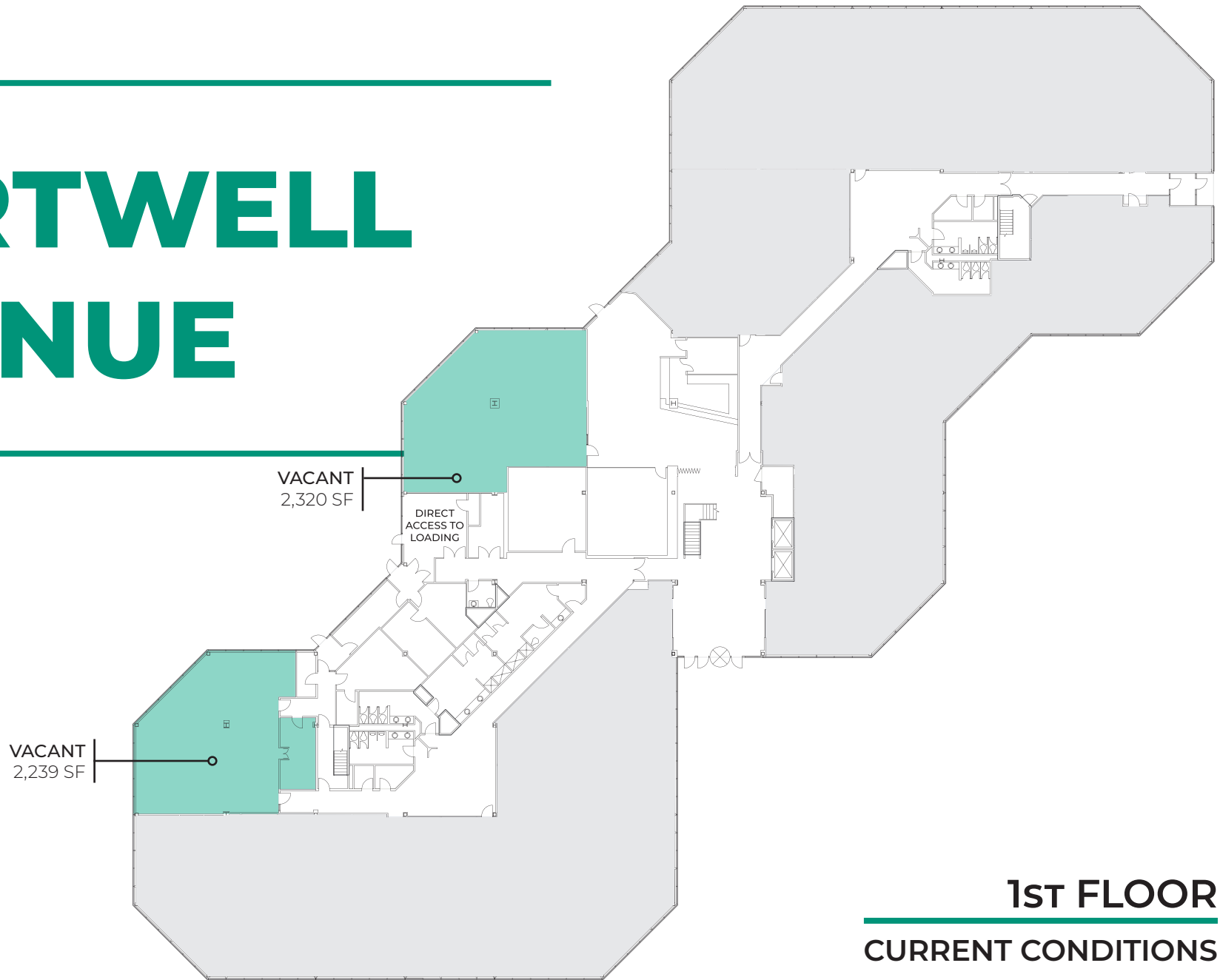

**1ST FLOOR**  
**CURRENT CONDITIONS**

**LINCOLN**  
PROPERTY  
COMPANY

**TIM LATHAM**  
Senior Vice President  
617.951.4104  
tlatham@lpc.com

**JEFFREY MOORE**  
Senior Vice President  
617.951.4161  
jmoore@lpc.com

**CHRIS DEVAUX**  
Vice President  
617.951.4124  
cdevaux@lpc.com

**CHRISTOPHER SCOTT**  
Assistant Vice President  
617.951.4135  
cscott@lpc.com

**JAMES TAMBONE**  
Associate  
617.951.4105  
jtambone@lpc.com

53 State Street, 8th Floor, Boston, MA 02109 | 617.951.4100 | www.lpcboston.com

Floor Plan measurements are approximate and are for illustrative purposes only. While we do not doubt the floor plans accuracy, we make no guarantee, warranty or representation as to the accuracy and completeness of the floor plan.